

INSERTI FILETTATI CILINDRICI GODRONATI INOX A4 - TESTA RIDOTTA



KNURLED CYLINDRICAL A4 STAINLESS STEEL THREADED INSERTS - REDUCED COUNTERSUNK HEAD

INSERTS FILETÉS CRANTÉS CYLINDRIQUES ACIER INOX A4 - TÊTE RÉDUITE

BLINDNIETMUTTERN RUNDSCHAFT GERÄNDELT EDELSTAHL A4 - KLEINER SENKKOPF

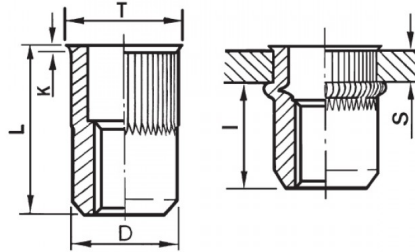
TUERCAS REMACHABLES CILINDRICAS ESTRIADAS INOX A4 - CABEZA REDUCIDA



	S GRIP	D +0,07/-0,1		T +/-0,5	K +/-0,15	L1	I ~	
M12	1,5 - 3,5	15,9	16	17,6	1,0	24	15	50

**MATERIAL: STAINLESS STEEL A4**

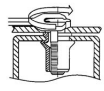
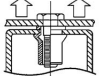
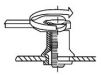
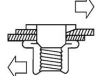
 MAX TIGHTENING TORQUE (Nm) 50	 PULL-OUT FORCE (N) 34000	 TORQUE TO TURN (Nm) 24	 SHEAR FORCE (N) 6500
--	---	---	---

Disegno di proprietà della Fixi S.r.l. - Non può essere copiato, riprodotto o comunicato a terze persone senza autorizzazione.  
Drawing owned by Fixi S.r.l.- It cannot be copied, reproduced or communicated to third parties without permission.

Disegnato da / Designed by: Ufficio Tecnico  
Ufficio Tecnico / Tech Office: tech@fixi.it

14/05/2026

**CODICE PRODOTTO / PART NUMBER**

85IXA4ITRGM12C16

**FIXI**<sup>®</sup>

FIXI s.r.l. Via Bellardi 40/A  
10146 - Torino (Italy)  
www.fixi.it - info@fixi.it