

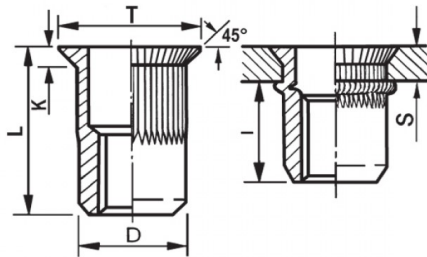



INSERTI FILETTATI CILINDRICI GODRONATI ACCIAIO - TESTA SVASATA
KNURLED CYLINDRICAL STEEL THREADED INSERTS - COUNTERSUNK HEAD
INSERTS FILETÉS CRANTÉS CYLINDRIQUES ACIER - TÊTE FRAISÉE
BLINDNIETMUTTERN RUNDSCHAFT SERÄNDELSTRAHL - SENKKOPF
TUERCAS REMACHABLES CILINDRICAS ESTRIADAS ACERO - CABEZA AVELLANADA



ZIGGINATO SOTTO LA TESTA
KNURLED UNDERNEATH THE HEAD

	S GRIP	D +0,07/-0,1	 +0,1-0	T +/-0,5	K +/-0,15	L +/-0,5	I ~	
M8	4 - 6.5	10.9	11	14	1.5	19	10	26

MATERIAL: STEEL ZINC PLATED CR III

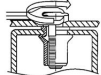
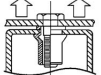
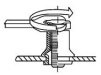
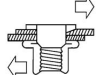
 MAX TIGHTENING TORQUE (Nm) 26	 PULL-OUT FORCE (N) 25000	 TORQUE TO TURN (Nm) 4,5	 SHEAR FORCE (N) 4400
--	---	--	---

Disegno di proprietà della Fixi S.r.l. - Non può essere copiato, riprodotto o comunicato a terze persone senza autorizzazione.
 Drawing owned by Fixi S.r.l. - It cannot be copied, reproduced or communicated to third parties without permission.

Disegnato da / Designed by: Ufficio Tecnico
Ufficio Tecnico / Tech Office: tech@fixi.it

08/07/2025

CODICE PRODOTTO / PART NUMBER

85ACITSGM08L

FIXI®

FIXI s.r.l. Via Bellardi 40/A
 10146 - Torino (Italy)
 www.fixi.it - info@fixi.it