

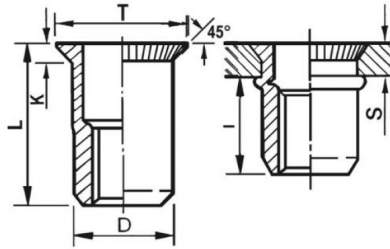



**INSERTI FILETTATI CILINDRICI - TESTA SVASATA**  
**CYLINDRICAL THREADED INSERTS - COUNTERSUNK HEAD**  
**INSERTS FILETÉS CYLINDRIQUES - TÊTE FRAISÉE**  
**BLINDNIETMUTTERN RUNDSCHAFT - SENKKOPF**  
**TUERCAS REMACHABLES CILINDRICAS - CABEZA AVELLANADA**



	S	D		T	K	L	I	
	GRIP	+0,07/-0,1	+0,1/-0	+/-0,5	+/-0,15	+/-0,5	~	
M10	1 - 4	11.9	12	15	1.5	18	10.5	45

**MATERIAL: STAINLESS STEEL A2**

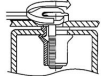
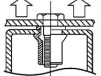
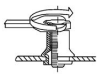
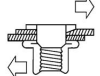
			
MAX TIGHTENING TORQUE (Nm)	PULL-OUT FORCE (N)	TORQUE TO TURN (Nm)	SHEAR FORCE (N)
45	32000	8,5	5000

Disegno di proprietà della Fixi S.r.l. - Non può essere copiato, riprodotto o comunicato a terze persone senza autorizzazione.  
 Drawing owned by Fixi S.r.l.- It cannot be copied, reproduced or communicated to third parties without permission.

**Disegnato da / Designed by:** Ufficio Tecnico  
**Ufficio Tecnico / Tech Office:** tech@fixi.it

14/05/2026

**CODICE PRODOTTO / PART NUMBER**

85IXITSM10C12\*

**FIXI®**

FIXI s.r.l. Via Bellardi 40/A  
 10146 - Torino (Italy)  
 www.fixi.it - info@fixi.it